

the Tea Maker™

STM800



EN QUICK GUIDE

Sage®



Contents

- 2 Important Safeguards
- 7 Components
- 9 Functions
- 12 Care & Cleaning
- 15 Troubleshooting

SAGE® RECOMMENDS SAFETY FIRST

At Sage® we are very safety conscious. We design and manufacture consumer products with the safety of you, our valued customer, foremost in mind. In addition we ask that you exercise a degree of care when using any electrical appliance and adhere to the following precautions.

IMPORTANT SAFEGUARDS

**READ ALL INSTRUCTIONS
BEFORE USE AND SAVE
FOR FUTURE REFERENCE**

- The full information book is available at sageappliances.com

- Before using for the first time please ensure that your electricity supply is the same as shown on the rating label on the underside of the appliance. If you have any concerns please contact your local electricity company.
- Remove and safely discard any packaging materials before first use.
- To eliminate a choking hazard for young children, safely discard the protective cover fitted to the power plug.
- This appliance has been designed specifically for the purpose of heating and boiling quality drinking water and tea only. Under no circumstances should this product be used to heat or boil any other liquids or foodstuffs.
- Position the appliance on a stable, heat resistant, level, dry surface away from the edge and do not operate on or near a heat source such as a hot plate, oven or gas hob.
- Do not place the appliance on or near a hot gas burner, electric element or where it could touch a heated oven.
- Position the appliance at least 20cm from walls or heat/steam sensitive materials and provide

- adequate space above and on all sides for air circulation.
- Do not operate the kettle on sink drain board.
 - Always ensure the appliance is properly assembled before connecting to a power outlet and operating. Follow the instructions provided in this book.
 - The glass jug must be used only with the power base supplied. Do not use on a range top.
 - The appliance is not intended to be operated by means of an external timer or separate remote control system.
 - Do not touch hot surfaces. Use the handle for lifting and carrying the glass jug.
 - Attach the jug lid securely to the glass jug before operation.
 - Do not place anything on top of the lid.
 - Do not open the jug lid during operation as scalding may occur.
 - Extreme caution must be used when moving the glass jug containing hot liquid.
 - Use caution when pouring water from the glass jug as boiling water and steam will scald. Do not pour the water too quickly.
 - To avoid scalding, never fill the glass jug past the 'WATER MAX' (when heating water) or 'TEA MAX' (when brewing tea) line markings.
 - Do not operate the appliance without water. Always fill the glass jug to at least the 'MIN' marking. Should it be operated without water, the boil-dry protection will shut the power off automatically. Allow the appliance to cool before refilling.
-  **WARNING**
- Do not remove the glass jug from the power base during heating or when the basket is in operation. Ensure the appliance has completed the water heating or tea brewing cycle before removing the glass jug from the power base.
 - The use of accessory attachments not recommended by Sage® may result in fire, electric shock or injury to persons.
 - To turn OFF the appliance, press the TEA/Cancel button (when brewing tea) or the HOT WATER/Cancel button (when heating water) on the power base. The appliance is OFF when the button surround illumination goes out.

- Always ensure the appliance is turned OFF, unplugged at the power outlet and has been allowed to cool before cleaning, attempting to move or storing.
- When the appliance is not in use or when left unattended, disconnect the power cord from the wall outlet.
- Allow the appliance to cool down in between brewing cycles.
- Keep the glass jug clean. Follow the cleaning instruction provided in this book.
- Do not use harsh abrasives or caustic cleaners when cleaning this appliance.
- Children should not play with the appliance.
- The glass jug has been specially treated to make it stronger, more durable and safer than ordinary glass, however it is not unbreakable. If dropped or struck extremely hard, it may break or weaken, and could at a later time shatter into many small pieces without apparent cause.
- Any maintenance other than cleaning should be performed by an authorised Sage® service centre
- The appliance can be used by children aged 8 or older and persons with reduced physical,

sensory or mental capabilities or a lack of experience and knowledge, only if they have been given supervision or instruction concerning use of the appliance in a safe way and understand the hazards involved.

- Children should not play with the appliance.
- Always turn the appliance to the off position, switch off at the power outlet and unplug at the power outlet when the appliance is not in use.



WARNING

- Do not wash jug exterior under running water.



IMPORTANT SAFEGUARDS FOR ALL ELECTRICAL APPLIANCES

- Fully unwind the power cord before operating.
- This appliance is for household use only. Do not use the appliance for anything other than its intended use. Do not use in moving vehicles or boats. Do not use outdoors. Misuse may cause injury.

- Do not let the power cord hang over the edge of a bench or table, touch hot surfaces or become knotted.
- Close supervision is necessary when any appliance is used by or near children.
- Cleaning of the appliance should not be carried out by children unless they are 8 year or older and supervised.
- The appliance and it's cord should be kept out of reach of children aged 8 years and younger
- Do not use the appliance if the power cord, power plug, or appliance becomes damaged in any way. If damaged and maintenance other than cleaning is required please contact Sage Customer Service or go to sageappliances.com



WARNING

- Do not operate the appliance on an inclined surface.
- Do not move the appliance while it is switched on.



The symbol shown indicates that this appliance should not be disposed of in normal household waste.

It should be taken to a local authority waste collection centre designated for this purpose or to a dealer providing this service. For more information, please contact your local council office.

The installation of a residual current safety switch is recommended to provide additional safety when using all electrical appliances. Safety switches with a rated operating current not more than 30mA are recommended. Consult an electrician for professional advice.



To protect against electric shock, do not immerse the glass jug base, power base, power cord or power plug in water or allow moisture to come in contact with these parts. Avoid spilling water onto the power base's connector. Do not immerse the glass jug or the power base for cleaning.

SAVE THESE INSTRUCTIONS



Components

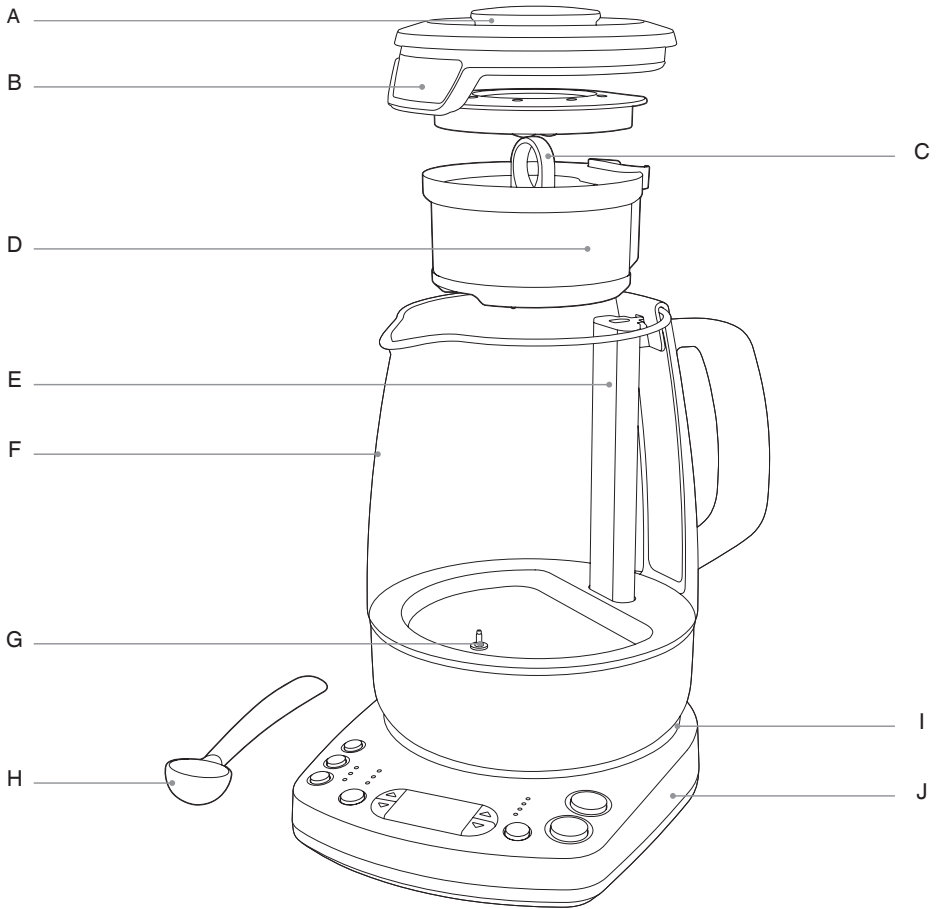

- | | |
|---------------------------------|--------------------------------|
| A. Jug lid | F. Glass jug |
| B. Stainless steel scale filter | G. Immersed temperature sensor |
| C. Tea basket lid | H. Tea scoop |
| D. Stainless steel tea basket | I. Power base |
| E. Jug post | J. Cord storage |



Rating Information
220-240V ~50Hz 1680-2000W



Components

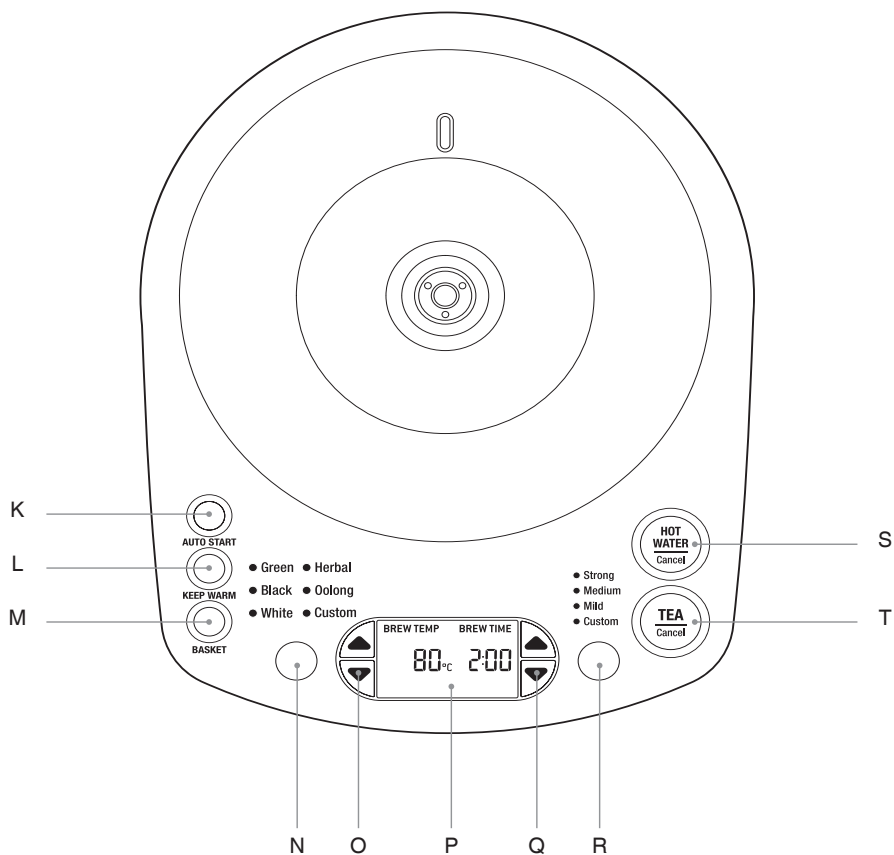

K. AUTO START button

L. KEEP WARM button

M. BASKET button

N. TEA TYPE button

O. Variable temperature control

P. Backlit LCD

Q. Variable time control

R. TEA STRENGTH button

S. HOT WATER/CANCEL button.

T. TEA/CANCEL button



Functions

BEFORE FIRST USE

In order to remove any dust or protective residues from the manufacturing process, it is recommended to run a boiling cycle then discard the water.

1. Unwind the power cord completely and insert the power plug into a grounded wall outlet.
2. Press the left **▲ ARROW UP** button until the LCD screen displays 100°C.



AUTO START



KEEP WARM



BASKET

● Green ● Herbal

● Black ● Oolong

● White ● Custom

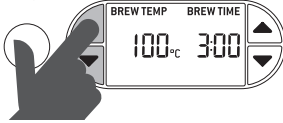

3. Press the **HOT WATER/Cancel** button to start the cycle.
4. Discard the water. The Tea Maker™ is now ready to use.

USE THE TEA MAKER™ FOR BREWING TEA

1. Fill with desired amount of water. Ensure you do not fill past the tea maximum mark (1200mL TEA MAX).
2. Place the basket on a flat, dry surface. Remove basket lid by lifting from the sides.

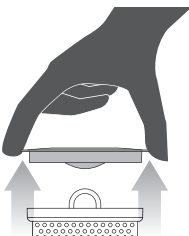

3. Use the provided tea scoop to fill the basket with tea leaves. As a general guide, use 1 scoop of tea leaves per cup/250ml of water.

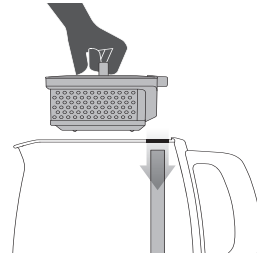

Selecting the tea type

Press the **TEA TYPE** button and toggle through until the desired tea.

Selecting the tea strength

The desired tea strength determines the brew time.

1. Press the **TEA STRENGTH** button and toggle through until the desired tea strength.
2. Press the **TEA/Cancel** button to start the tea brewing cycle.
3. Once the selected brew temperature is reached the assembled basket will automatically lower into the heated water.
4. Once the basket reaches the bottom of the glass jug, the LCD screen will indicate the brewing progress.
5. At the end of the tea brewing cycle, the basket will automatically rise to the top of the glass jug.



WARNING

The tea basket is hot to touch after tea is brewed. Ensure the tea basket handle has cooled before handling.

TEA TYPE	GREEN TEA	WHITE TEA	OOLONG TEA	HERBAL TEA	BLACK TEA
PRESET BREW TEMP	80°C	85°C	90°C	100°C	100°C
PRESET BREW TIME	3:00	3:00	3:00	4:00	2:00

Selecting the 'Keep Warm' Feature

This feature allows the brewed tea or heated water to remain warm for up to 60 minutes.

1. Press the KEEP WARM button before, during or after completion of the tea brewing or water heating cycle.
2. If the glass jug is removed from the Power Base, the 'Keep Warm' feature will automatically switch off. You can re-select the 'Keep Warm' feature by pressing the KEEP WARM button.

Selecting the 'Basket Cycle' Feature

This feature continuously auto lifts and lowers the basket during the tea brewing cycle.

To activate the 'Basket Cycle' feature, press the BASKET button once.

USE AS A VARIABLE TEMPERATURE KETTLE

1. Fill the glass jug with the desired amount of water.
2. a) **To boil water (100°C):**
Press the left ▲ ARROW UP button to increase the temperature to 100°C.
- b) **To heat water to a customised temperature:**
Press the left ▲ ARROW UP button to increase the temperature, or the left ▼ ARROW DOWN button to decrease the temperature.

- Green
- Black
- White
- Herbal
- Oolong
- Custom

- Strong
- Medium
- Mild
- Custom

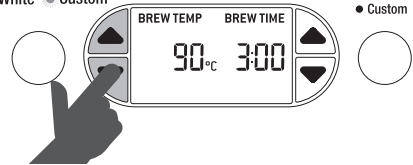

3. Press the HOT WATER/Cancel button to start the cycle.
4. Once the selected temperature is reached, the tea alert will sound three times. The LCD screen will automatically display the 'Time Since Brew' function. This function counts up to a maximum of 60 minutes, allowing you to monitor when the water heating cycle was complete. It does not activate the heating elements.

CUSTOMISING BREW TEMPERATURE

Press the left ▲ ARROW UP button to increase the temperature, or the left ▼ ARROW DOWN button to decrease the temperature.

NOTE

This product is not calibrated for commercial or scientific use. Temperatures may vary $\pm 3^{\circ}\text{C}$, which is within range for optimal brewing for each tea variety.

CUSTOMISING BREW TIME

Brew time less than 10 minutes

Press the right ▲ ARROW UP button to increase the time, or the right ▼ ARROW DOWN button to decrease the time.

Manual mode-brew times over 10 minutes

- i) Press the right ▲ ARROW UP button to increase the time up to the maximum 10 minutes.
- ii) Continue to press the right ▲ ARROW UP button. The LCD screen will display 'MANUAL LIFT' and ':-:-' on the right side of the LCD.
- iii) Once the Tea Maker™ is activated and the correct water temperature is reached, the basket will automatically lower.
- iv) Once the desired brew time has elapsed, press and hold the BASKET button for 2 seconds. The basket will rise.

AUTO START FEATURE

1. Press and hold the AUTO START button for 2 seconds.
2. To set the CURRENT TIME, press the left ▲ ARROW UP button to increase the time, or the left ▼ ARROW DOWN button to decrease the time in 1 minute increments.
3. To set the START TIME, press the right ▲ ARROW UP button to increase the time, or the right ▼ ARROW DOWN button to decrease the time.
4. Once current time and start time are programmed, press either the flashing HOT WATER/Cancel or TEA/Cancel button to select which feature you would like to start at the programmed time.

5. Ensure that the Tea Maker™ is prepared with:
 - a) Sufficient water in the glass jug and tea leaves in the basket for the tea brewing cycle or,
 - b) Sufficient water in the glass jug for the water heating cycle.



NOTE

Insufficient water may discolour your Tea Maker™ base!



NOTE

The 'Auto Start' feature can be cancelled anytime by pressing the AUTO START button.



Care & Cleaning

CLEANING THE GLASS JUG

1. After each use, empty the glass jug. Do not allow brewed tea to stand overnight.
2. Wipe the interior of the glass jug with a soft damp sponge or rinse with warm water. Tea deposits will enhance the flavour of the brewed tea, so if only using as a Tea Maker™ do not wash with soapy water.
3. Wipe the exterior of the glass jug with a soft damp cloth to clean.



4. To remove the build-up of tannin, the astringent chemical constituent of tea, fill the glass jug with water up to the water maximum mark (1500mL WATER MAX) and bring water to boil and allow water to cool for one minute. Add contents of tea cleaner packet and allow to stand for 5 minutes. Empty Tea Maker™, refill with fresh water and boil. Repeat this step again. Empty Tea Maker™ and rinse thoroughly.
5. Dry thoroughly with a soft lint-free cloth before using.

NOTE

Allow all parts of the Tea Maker™ to cool completely before disassembling and cleaning.

NOTE

Only the jug lid, tea basket, tea basket lid and tea scoop are dishwasher safe.

CLEANING THE JUG LID AND INTEGRATED SCALE FILTER

1. Wash the jug lid in warm soapy water with a soft sponge, rinse and dry thoroughly. The integrated scale filter can be cleaned by placing under running hot water and rubbing with a cleaning cloth or brush.
2. Alternatively, the jug lid is dishwasher safe. Position the jug lid vertically so the scale filter is facing upwards. This will allow water to drain properly.
3. Let all surfaces dry thoroughly prior to using.

CLEANING THE TEA BASKET LID, TEA BASKET AND TEA SCOOP

1. Wash the tea basket lid, tea basket and tea scoop in warm soapy water with a soft sponge, rinse and dry thoroughly. A non-abrasive liquid cleanser or mild spray solution may be used to avoid build-up of stains. Apply the cleanser to the sponge, not the accessory surfaces, before cleaning.
2. Alternatively, these accessories are dishwasher safe.
3. Let all surfaces dry thoroughly prior to using.

CLEANING THE POWER BASE

4. Wipe the power base with a soft damp sponge.
5. Let all surfaces dry thoroughly prior to inserting the power plug into a wall outlet.

DESCALING

Use Sage® “The Descaler” to remove scale build up. To order visit www.sageappliances.com.

6. Empty one sachet (25g) into 1 litre of warm water, stir to dissolve.

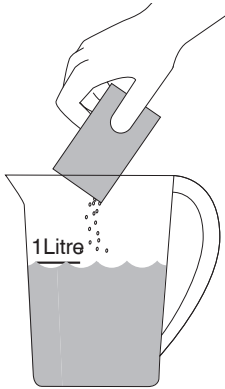

7. Pour into the tea maker.

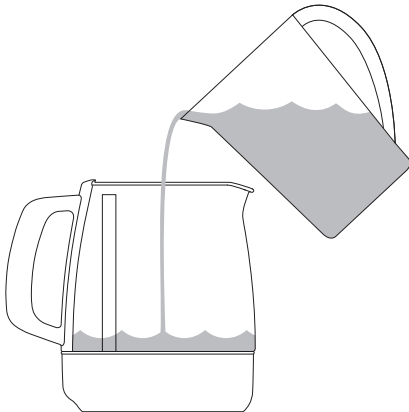

8. Leave stand for 5 minutes.
9. After 5 minutes, discard the solution.
10. Rinse the tea maker twice with fresh clean water.

STORAGE

1. Ensure the Tea Maker™ is switched off, cleaned and dried before storing.
2. Ensure that the assembled tea basket is securely attached to the magnetic post within the glass jug.
3. Ensure that jug lid is securely in place.
4. Wrap the power cord around the power cord storage under the power base.
5. Stand the Tea Maker™ upright on the power base. Do not store anything on top.



Troubleshooting

PROBLEM

POSSIBLE CAUSE

Tea Maker™ will not switch 'ON'

- Check the power plug is securely inserted into the outlet.
- Insert the power plug into an independent outlet.
- Insert the power plug into a different outlet.
- Reset the circuit breaker if necessary.
- For additional safety the Tea Maker™ is fitted with a thermal cut out. In the event of severe overheating, the Tea Maker™ will automatically shut down to prevent further damage. Should this continue, visit Sage Customer Service at sageappliances.com.

The Tea Maker™ will not work

- Check the glass jug is securely positioned on the power base.

The LCD light has gone out?

- The Tea Maker™ goes into standby mode if not used for 3 minutes.
- To re-activate the Tea Maker™ out of standby mode:
 - Remove then replace the glass jug from the power base.
 - Press any button on the power base except the HOT WATER/Cancel or TEA/Cancel buttons. The LCD screen will re-illuminate.

I cannot select a certain function

- Certain features cannot be selected or changed during the heating or brewing cycle. The LCD screen may temporarily change or a sound alert may be heard, but no changes to the cycle will be made.

The LCD screen displays 'RESET'

- The LCD screen will display a flashing 'RESET' when there is a resettable electronic issue. Remove the plug from the wall outlet, wait 5 seconds, then plug back in.
- Visit Sage Customer Service at sageappliances.com if the 'RESET' message continues.

The LCD screen displays 'ERROR'

- The LCD screen will display a flashing 'ERROR' when there is a non-resettable issue with the appliance. Should this occur, visit the Sage Customer Service at sageappliances.com.
-



Troubleshooting

PROBLEM

WHAT TO DO

I would like to have the Tea Maker™'s default settings back

- Even when unplugged from the wall outlet, the Tea Maker™ will remember the last setting used for each function.
- To restore the Tea Maker™'s default settings for each function, simultaneously press and hold AUTO START and KEEP WARM buttons for 2 seconds.

The 'BASKET CYCLE' feature/BASKET button does not work

- The basket cycle is only operational during brewing cycles that are under 10 minutes.
- The tea basket cannot be lowered during the heating up phase of normal operation.

After boiling water, bubbles appear around the temperature sensor

- This is normal for the functionality of the Tea Maker™.

My tea tastes too weak or too strong

- Perform a cleaning cycle as per instruction in the booklet.
- Add milk/liquid BEFORE drinking powder is added to the jug.

There is a rattling noise inside the glass jug

- This is normal. The noise is from the magnet located inside the jug post and may be heard when the tea basket is not attached.
-



Freephone (UK Landline): 0808 178 1650
Mobile Calls (National Rate): 0333 0142 970

www.sageappliances.co.uk
customerservice@sageappliances.co.uk

Register your product and get more from your purchase

Product registration takes only a few minutes and ensures a record of your purchase. Registration also makes it easier to get support and advice on any questions or issues that you might have in the future. If you wish, we can also send you free recipes and additional hints and tips on making the best of your appliance.

➤ Go to www.sageappliances.co.uk and click on 'Product Registration'.

What's on your mind?

Our constant aim is to improve the quality and features of our appliances. We welcome your comments and ideas in assisting our ongoing development.

➤ Go to www.sageappliances.co.uk and click on 'Support'.



Registered in England & Wales No. 8223512. Due to continued product improvement, the products illustrated or photographed in this document may vary slightly from the actual product.

Copyright BRG Appliances 2017.

STM800